

LET'S  
CONNECT!



VISIT  
US



Exhibition  
& Convention  
Centre



TRADE FAIRS  
CONVENTIONS  
CONFERENCES  
TRAINING SESSIONS  
CONCERTS & SHOWS  
BUSINESS MEETINGS  
GALA EVENTS & PROMS  
FESTIVALS  
SPORTS EVENTS  
LIVE SHOWS

good **TO BE** here





UNLOCK YOUR  
OPPORTUNITIES  
WITH US



## VENUE WITH CHARACTER



Iconic & highly regarded.

Designed to host  
a wide variety of events.



STATE OF THE ART  
TECHNOLOGY

**PRESTIGIOUS**  
SURROUNDINGS

Perfectly situated  
next to one of Europe's  
most stunning football stadiums.



**AS INTRIGUING**  
AS AMBER

**AS ATMOSPHERIC**  
AS GDAŃSK



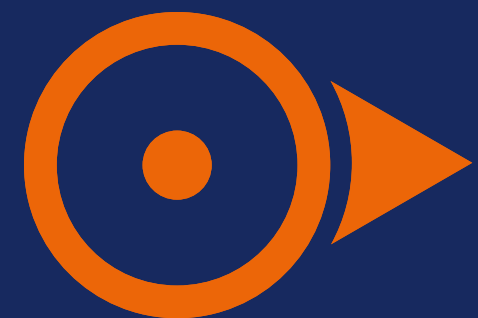

## EXCELLENT LOCATION

**5KM**  
TO THE CENTRE  
OF GDANSK

**4KM**  
TO THE BEACH



**11KM**  
TO SOPOT

**14KM**  
TO THE AIRPORT



**17KM**  
TO GDYNIA

**26KM**  
TO THE A1 MOTORWAY



## CAR PARKS



**430**  
PARKING SPACES  
AT AMBEREXPO



**8**  
DISABLED  
SPACES



ELECTRIC CAR  
CHARGING STATIONS



ROLLING STOCK  
AND RAIL VEHICLE  
EXHIBITING  
OPPORTUNITIES

**2,000**  
PARKING SPACES  
AT THE POLSAT PLUS  
ARENA GDAŃSK  
STADIUM

**25**  
DISABLED  
SPACES

## AIR LINKS



### 10 AIRLINES

PLL LOT, LUFTHANSA, KLM, SAS, SWISS,  
FINNAIR, EUROWINGS, NORWEGIAN,  
RYANAIR, WIZZ AIR



**1h** - WARSAW  
**1h** - COPENHAGEN  
**1h** - SZTOKHOLM  
**1,5h** MUNICH FRANKFURT, OSLO  
**1,5h** - AMSTERDAM  
**2h** - LONDON  
**3h** - BARCELONA  
**3h 15MIN** - BUDAPEST

**15KM FROM THE AIRPORT  
TO THE CENTRE OF GDAŃSK**

ca. 20min

25min

40min

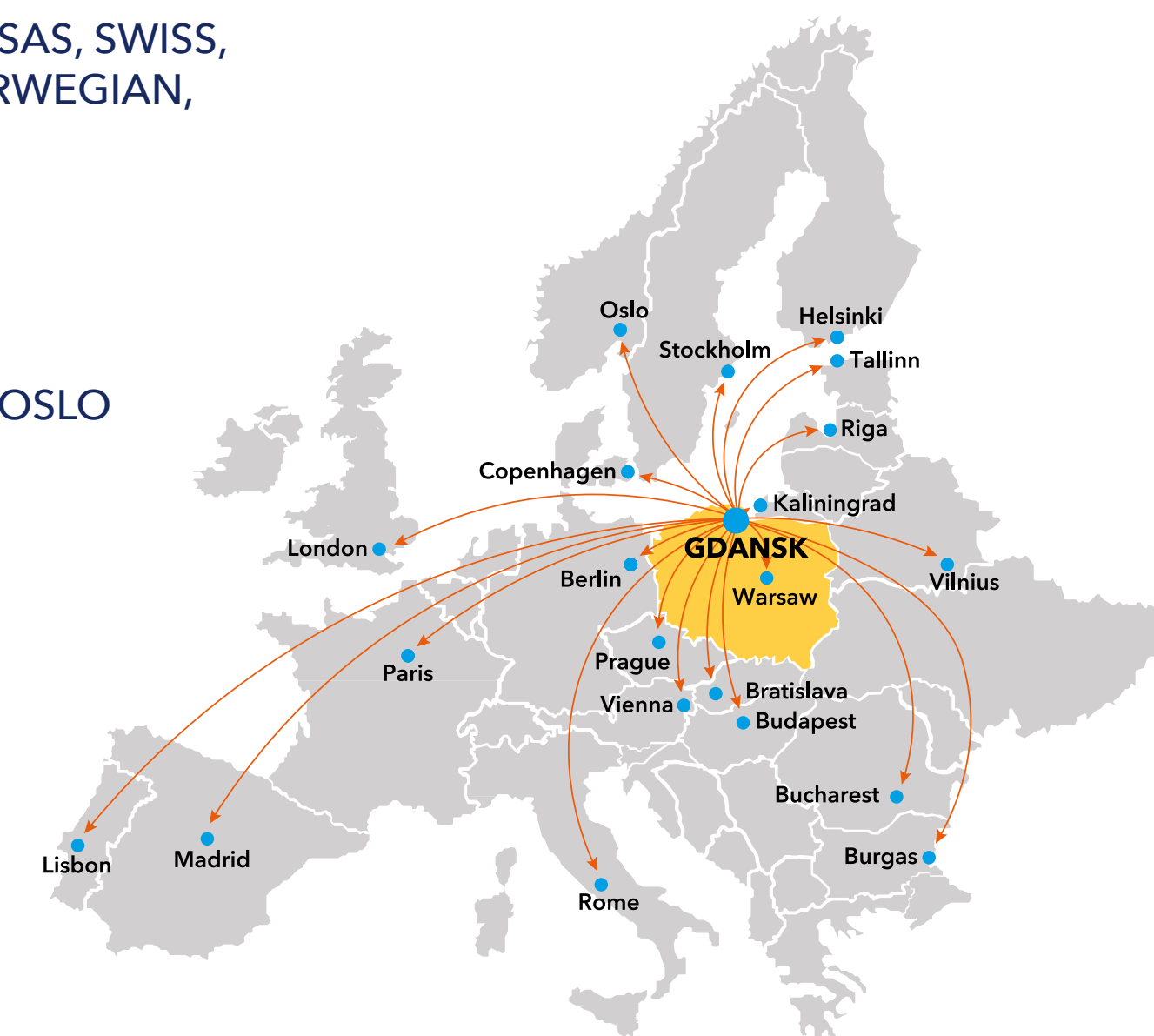



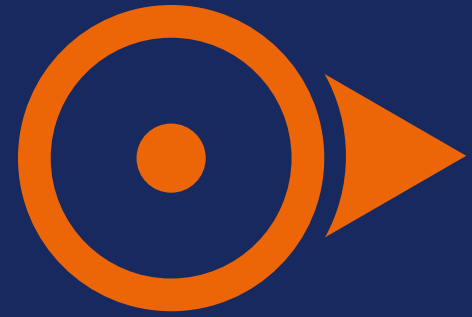

# HOTELS & TOURISM



**61** CATEGORISED HOTELS **\*\*\_\*\*\*\*\***



**10,800** HOTEL BEDS ACROSS VARIOUS CATEGORIES PLUS EXTRA CAPACITY IN UNCATEGORISED ACCOMMODATION A WIDE RANGE OF OPTIONS FROM LARGE GLOBAL HOTEL CHAINS TO BOUTIQUE HOTELS. CITY CENTRE HOTELS WITHIN A 15-20 MINUTE WALKING DISTANCE



## NUMBER OF MEETINGS

**981** IN ICCA COUNTRY CITY RANKINGS  
**98<sup>TH</sup>** PLACE IN EUROPE  
**196<sup>TH</sup>** PLACE IN THE WORLD

KEY SECTORS:  
ICT, BUSINESS SERVICES, LOGISTICS, ELECTRONICS,  
BIOTECHNOLOGY



**4000KM**  
OF CYCLE ROUTES



**1200KM**  
OF KAYAKING TRAILS  
- 153 CANOE KAYAK  
LANDING STAGES



**68** BOATING HARBOURS MARINAS  
- 2,500 MOORINGS

source:  
Pomeranian Regional  
Tourism Organisation



RESTAURANTS



PUBS  
CLUBS



OBSERVATION  
WHEEL



MUSEUMS  
HERITAGE SITES



THE SEA  
BEACH



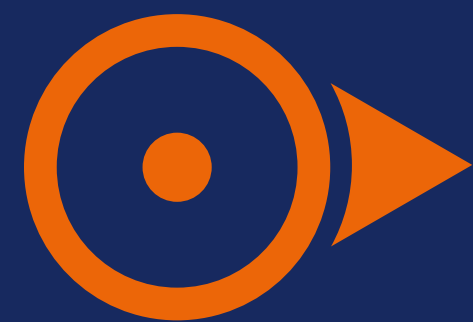

# MULTIFUNCTIONAL EXHIBITION HALLS

HALLS **A** **B** **C** **D** **E**

**16 700m<sup>2</sup>**

- mobile partition walls
- flexible space configurations: 1,000, 2,000, 4,000, 8,000, 10,000 or 16,700m<sup>2</sup>
- dedicated lobby for each hall
- special sound insulation & curtains for halls and mezzanine
- seamless hosting of multiple simultaneous events
- full infrastructure for large-scale events
- convenient access to the Conference Centre and VIP Area
- extensive technical capabilities

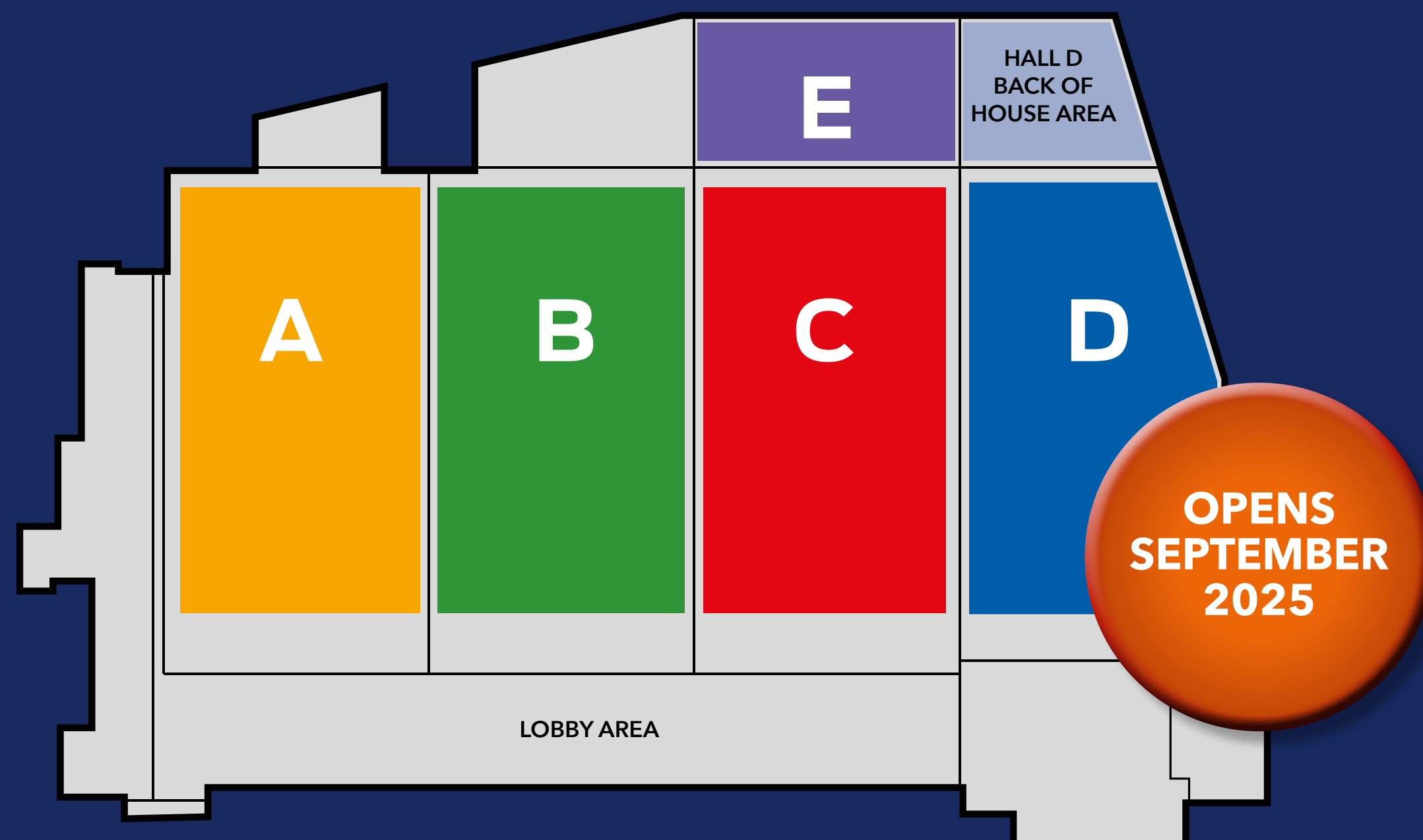

## OUTSTANDING NEW HALL

**3 700m<sup>2</sup>**

ONE OF A KIND  
IN POMERANIA



NEW FUNCTIONS  
NEW CAPABILITIES



- DOMESTIC & INTERNATIONAL CONGRESSES CONFERENCES
- MUSIC FESTIVALS
- LARGE SCALE LIVE SHOWS
- CORPORATE EVENTS
- FILM & ADVERTISING PRODUCTIONS

## NEW CAPABILITIES

- spacious and elegant lobby featuring a fountain and bar on Level 0, with a restaurant on Level 1
- full blackout capability and advanced technological fit-out in the Hall, based on expert Stage Technology solutions
- venue sound system
- CCTV venue monitoring system
- outside broadcasting (OB) truck access points
- technical conduit for wired connectivity between the control room and the hall floor
- perimeter walkway and backdrop system
- dedicated control room
- service stairway providing direct access from the hall to the control room and walkway
- acoustically insulated from the rest of the complex, with sound containment and prevention of external noise interference
- high-load-bearing flooring
- independent air conditioning system
- mezzanine overlooking Hall D with direct access to the VIP Lounge
- four dressing rooms with en-suite bathrooms and a make-up room in the hall's back-of-house area
- loading bay accessible for HGV size delivery vehicles





**OPENS  
SEPTEMBER  
2025**





HALL D								
total floor area dimensions	floor load capacity	gates	sound insulation of building elements	utility ducting systems	rigging grid	back of house area		
<div>3,700m<sup>2</sup> 43.5 x 85m</div>	<div>UNIFORMLY DISTRIBUTED LIVE LOAD 50kN/m<sup>2</sup></div> <div>CONCENTRATED LOAD 100kN/m<sup>2</sup> PER 150 X 150 MM PLATE</div>	<div>T1</div> <div>T2</div>	<div>EXTERNAL WALL R' <sub>A2</sub> = 53dB</div> <div>ROOF STRUCTURE R' <sub>A2</sub> = 38 ÷ 42dB ((standard requirement: R' <sub>A2</sub> = 25dB)</div> <div>WEST FACING GATE ASSEMBLY</div>	<div><ul style="list-style-type: none"><li>• cold water</li><li>• wastewater drainage</li><li>• 230V and 0.4kV 3-phase power supply category 6A structured cabling</li><li>•</li></ul></div>	<div><ul style="list-style-type: none"><li>• 67 rigging points, 11kN each (gross capacity, including hoist weight)</li><li>• 67 chain hoists, 1,000kg load capacity, D8+ safety class, 4m/min lift speed</li></ul></div>	<div>1,514m<sup>2</sup></div> <div>CEILING CLEARANCE</div> <div>12 m</div>		
ceiling clearance					<div>EXTERNAL GATE Rw = 36dB</div> <div>+ + THERMAL GATE R = 26dB</div> <div>MOBILE PARTITION TO HALL C C Rw= 44÷54dB</div>	reverberation time by frequency	lighting	lobby area
<div>TO ROOF STRUCTURE 12m</div> <div>TO TECHNICAL WALKWAY 9,95m</div>						<div>125 ÷ 4000Hz: 1,48 ÷ 0,69 seconds</div>	<div><ul style="list-style-type: none"><li>• venue lighting</li><li>• natural light:</li></ul>- roof skylights with blackout system<ul style="list-style-type: none"><li>• smoke vents:</li></ul>- non-transparent, light-blocking</div>	



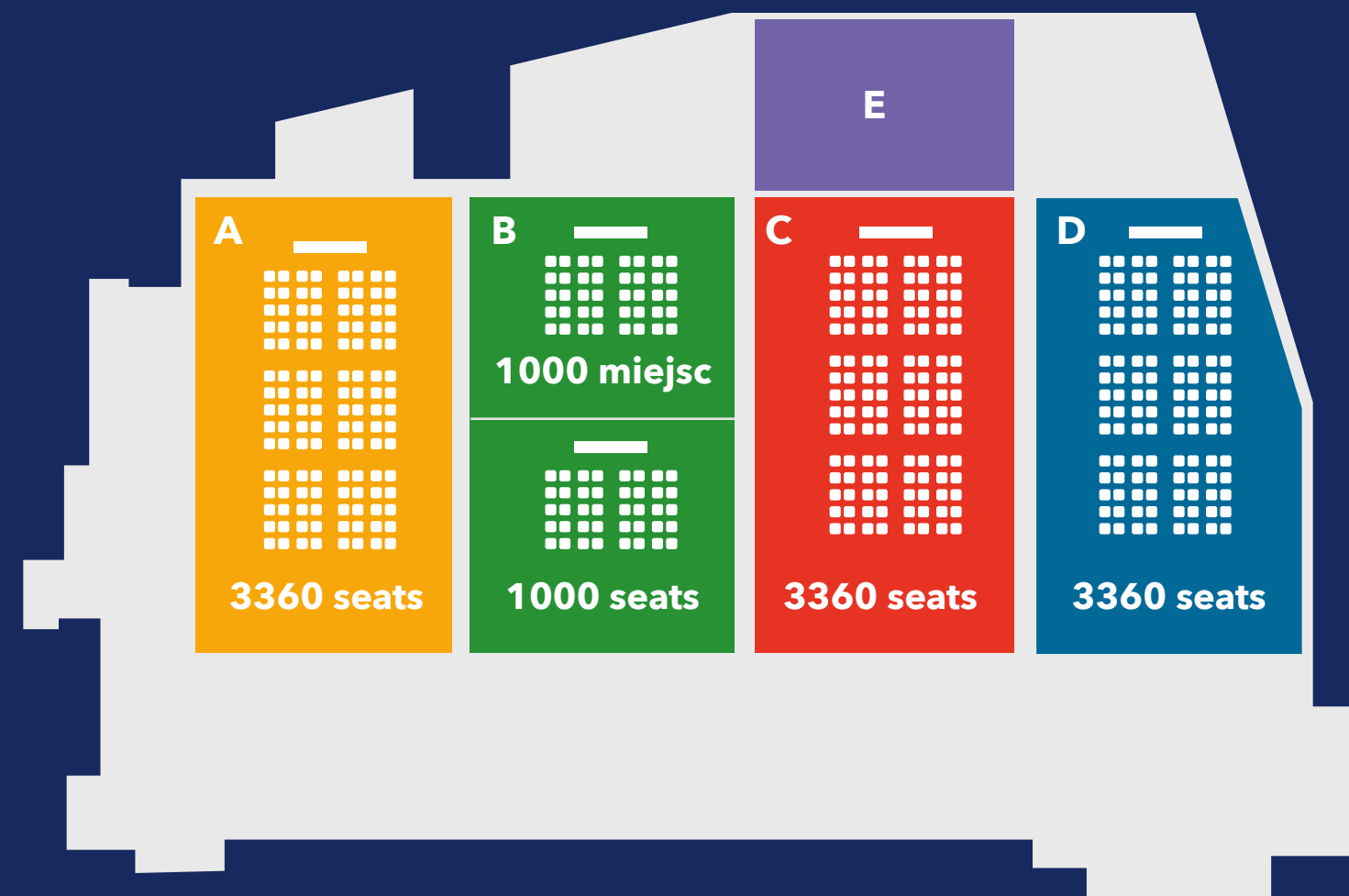

THEATRE  
STYLE LAYOUT

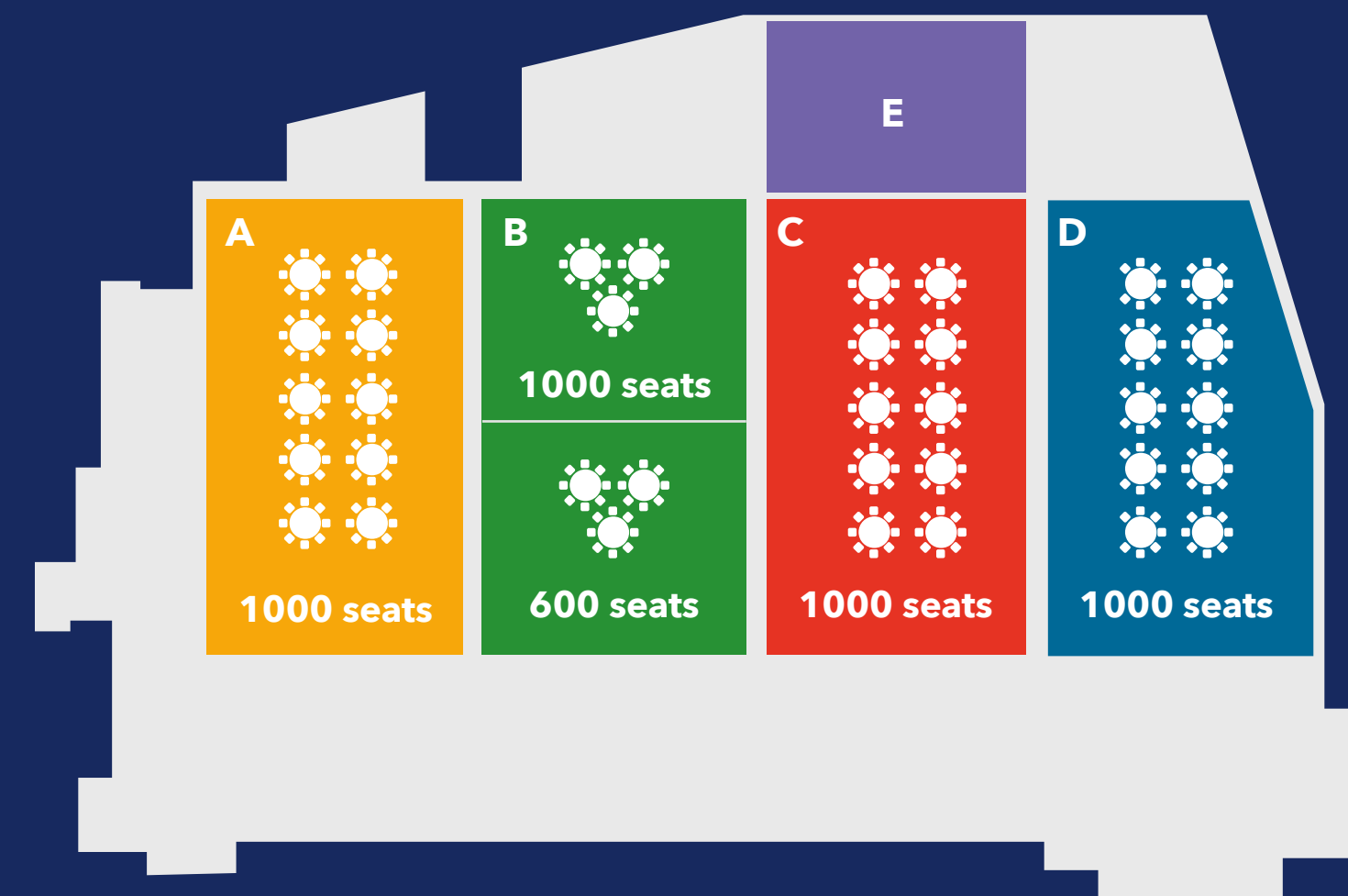
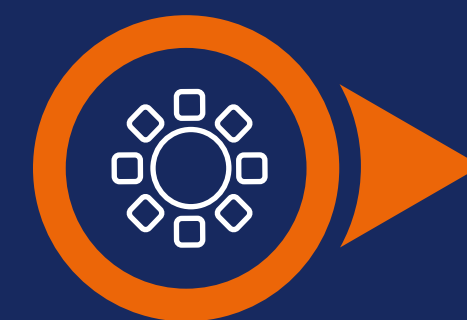

BANQUET  
STYLE LAYOUT







**HOTEL** ★ ★ ★

- to be located above the entrance to the new hall
- on floors 3-7
- operated by Ibis Style
- 160 rooms
- premium rooms with access to a viewing terrace

EXPANSION & NEW  
OPPORTUNITIES

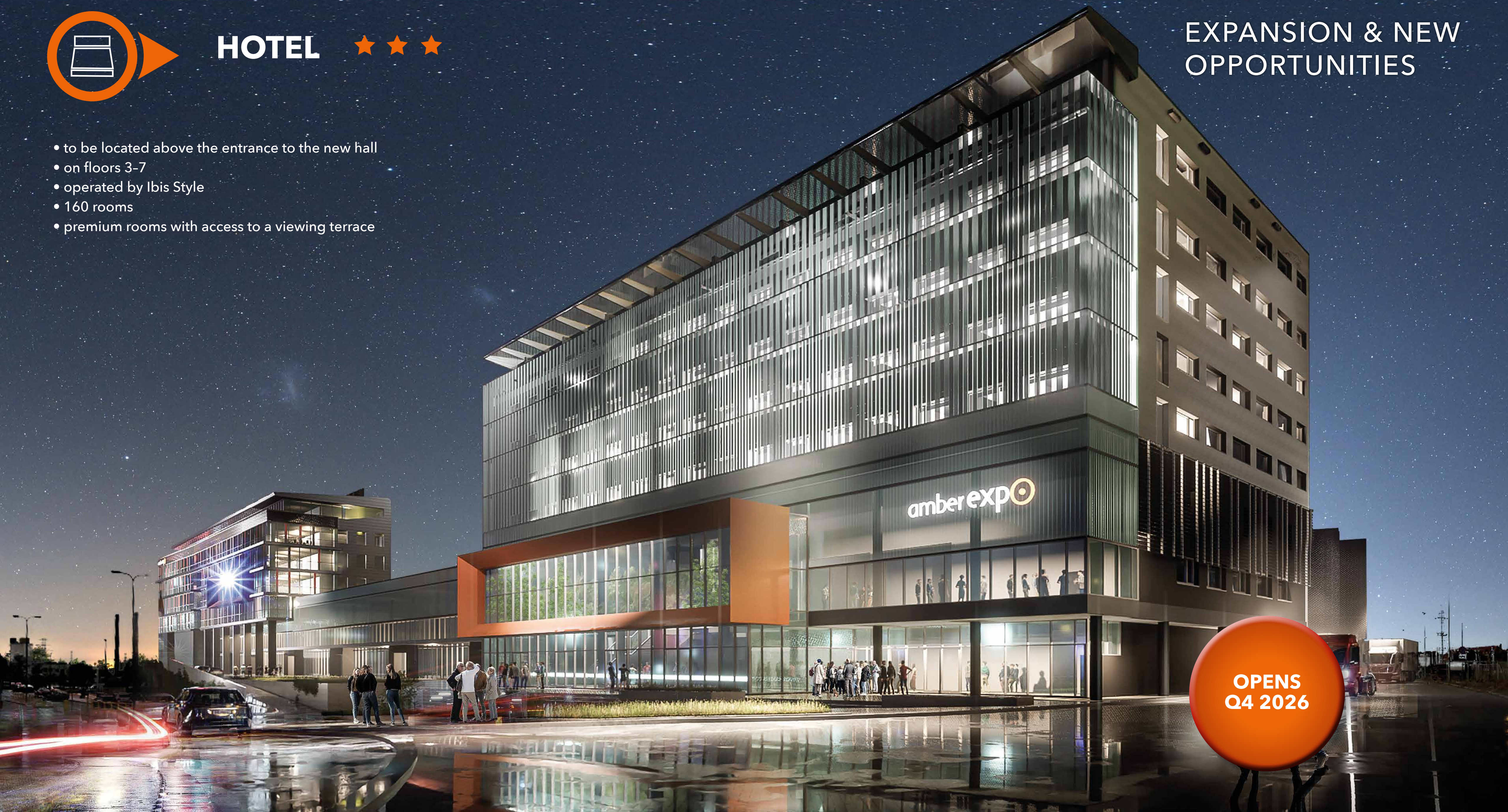

**OPENS  
Q4 2026**



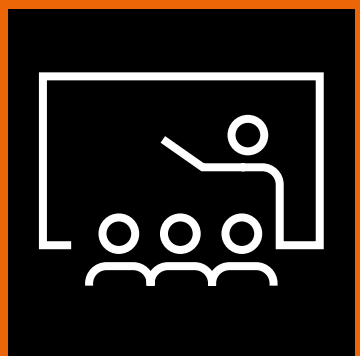

# CONFERENCE CENTRE

## 5 MULTIMEDIA CONFERENCE ROOMS

- overlooking the Amber Stadium – a jewel among global sports venues
- largest room accommodates 546 participants – can be divided into two or three smaller rooms using a mobile partition system
- three additional rooms with 320, 130 and 54-person maximum seating capacity
- all rooms feature state-of-the-art multimedia equipment
- dual access: from the lobby or directly from the exhibition halls
- spacious lobby perfect for catering, relaxation areas and partner/sponsor exhibitions

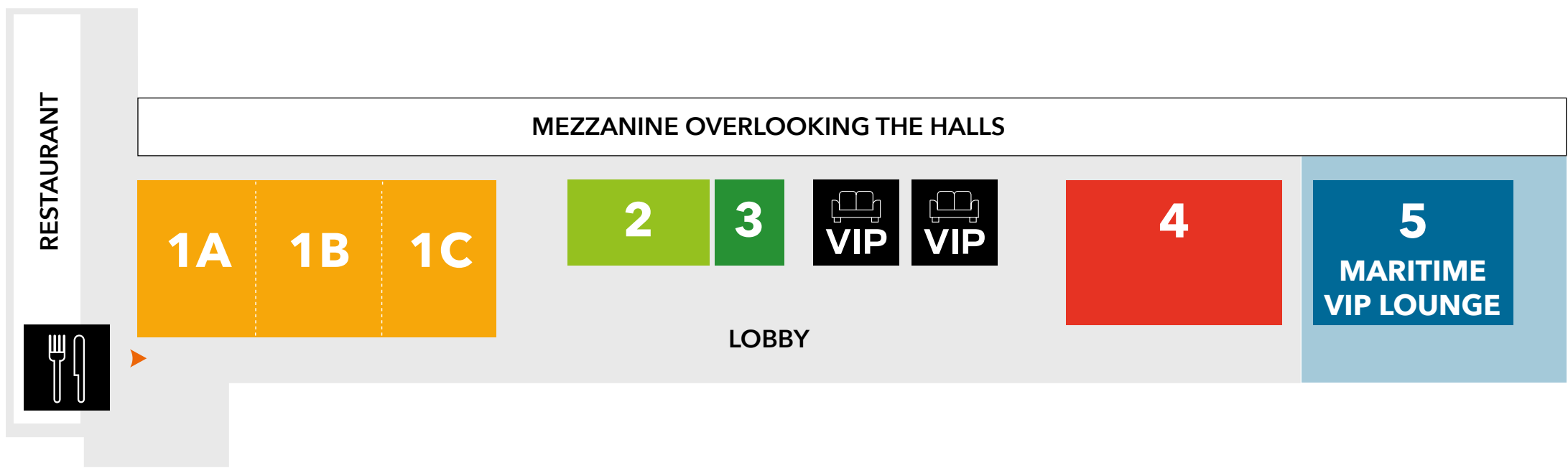

1	1A	1B	1C	2	3	4	5
33.5 x 16m	10 x 16m	8.5 x 16m	15 x 1 m	15 x 8.6m	7.5 x 8.7m	22.5 x 15m	13.5 x 18m
height 5.55m				height 3.3m	height 2.3m	height 4m	



### AVAILABLE EQUIPMENT

- |                                 |                                    |                                  |                  |
|---------------------------------|------------------------------------|----------------------------------|------------------|
| MOBILE PARTITION WALL IN ROOM 1 | LED BAR LIGHTING                   | CEILING MOUNTED SOUND SYSTEM     | AIR CONDITIONING |
| MOBILE DS SCREENS               | PROJECTORS                         | 2 MICROPHONES                    | LAPTOPS          |
| LARGE FORMAT LED SCREENS        | DS SCREEN OUTSIDE CONFERENCE ROOMS | HEAD TABLES                      | LECTERN          |
| PRESENTATION POINTER            | SIMULTANEOUS INTERPRETATION SYSTEM | PTZ TRACKING CAMERA FOR SPEAKERS | WIFI             |





layout type	1	1A	1B	1C	2	3	4	5
theatre	546 seats	132 seats	121 seats	200 seats	130 seats	54 seats	320 seats	200 seats
U-shape	x	18 tables 36 seats	17 tables 4 seats	20 tables 40 seats	15 tables 30 seats	8 tables 16 seats	27 tables 54 seats	20 tables 40 seats
classroom	112 tables 224 seats	35 tables 70 seats	28 tables 56 seats	48 tables 96 seats	20 tables 40 seats	12 tables 24 seats	63 tables 126 seats	48 tables 96 seats
banquet	25 tables 250 seats	x	x	x	x	x	16 tables 160 seats	x

 rectangular tables: 2 seats each / 70 x 150cm

 banquet tables: 10 seats each / Ø 180cm





## 6 VIP ROOMS

AMBEREXPO offers six custom-designed, fully equipped VIP Rooms, perfect for business meetings, training sessions and recruitment processes. They can function as standalone meeting rooms or as additional breakout spaces for conferences. The VIP Room Area provides 6 rooms, designed to accommodate 4 to 9 individuals each.



**200**  
SEATS ON  
THE MEZZANINE



CONVENIENCE  
& COMFORT



## MARITIME VIP LOUNGE

WITH A VIEW  
OF HALL D

The Maritime VIP Lounge is a sleek, modern space designed for banquets, exclusive concerts and business gatherings. It features a glass wall with a direct view of Hall D. The adjacent lobby offers a spacious pre-event area with direct access to the restaurant.



**250**  
SEATS



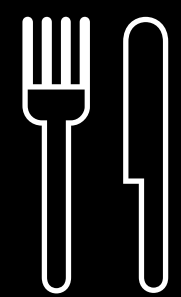

# Amber Side

catering & restaurant

RESTAURANT  
CAFÉ  
BAR

AmberSide is our Exclusive Catering Partner.

- full-service catering for trade fairs, conferences and private meetings in the VIP Area
- in-house catering infrastructure, furniture and tableware
- menus, formats and ingredients tailored in consultation with an experienced team

AmberSide's second restaurant, TYGIE GDAŃSKIE, has been awarded a prestigious Michelin Guide 2024 recommendation, making it the perfect venue for high-end business meetings.

CONTACT: MARTA ZALEWSKA / +48 784 926 284 / M.ZALEWSKA@AMBERSIDE.PL

## NEW FOOD & BEVERAGE AREA



BAR  
36 SEATS

RESTAURANT  
116 SEATS



TOP LEVEL SERVICE  
& EXPERIENCE





# KOT

80-886 Gdańsk, PL  
Garncarska 18/20

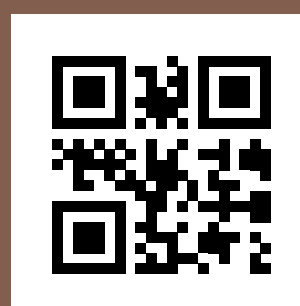

## NEW DIMENSION OF CULTURE IN THE HEART OF GDAŃSK

Project completed by the MTG SA Gdańsk International Fair Co. in 2024.

This one-of-a-kind venue with soul blends history and modernity, offering a space where culture unites generations. Housed in a restored townhouse, it welcomes music lovers, film enthusiasts, art aficionados and food connoisseurs alike. Whether you are planning a meeting, a relaxed event or a banquet, KOT provides versatile, stylish interiors in the very heart of the city.

CONTACT: [KONTAKT@KLUBKOT.PL](mailto:KONTAKT@KLUBKOT.PL)



## YOUR IDEAL VENUE FOR EVENING NETWORKING EVENTS AT TRADE FAIRS & BUSINESS GATHERINGS

**MONK**  
- COCKTAIL BAR & LIVE STAGE CLUB

**SPEKTRUM**  
CINEMA HALL WITH PROFESSIONAL AUDIOVISUAL  
EQUIPMENT FOR 100 ATTENDEES

**MIAU MIAU**  
COSY MEZZANINE CAFÉ WITH A UNIQUE  
ATMOSPHERE

**MASŁO MAŚLANE**  
MODERN POLISH CUISINE RESTAURANT

**PIZZA CAT**  
PARADISE FOR PIZZA LOVERS

**OFF**  
INDEPENDENT CINEMA SHOWCASING  
DOCUMENTARIES, EXPERIMENTAL FILMS AND  
ARTHOUSE PRODUCTIONS

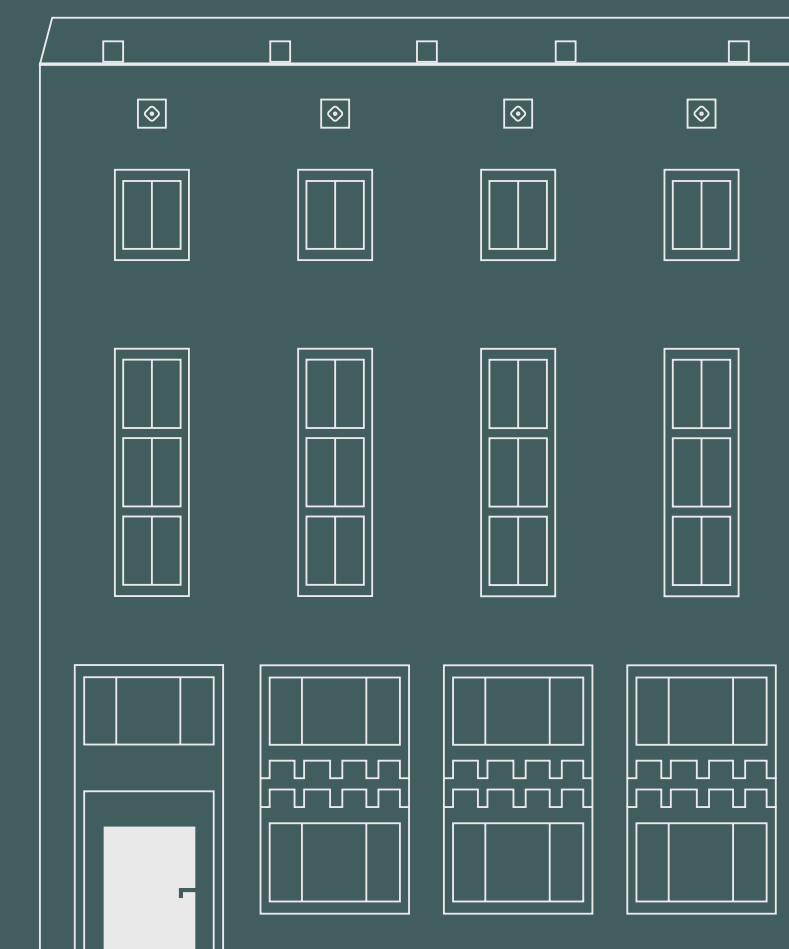
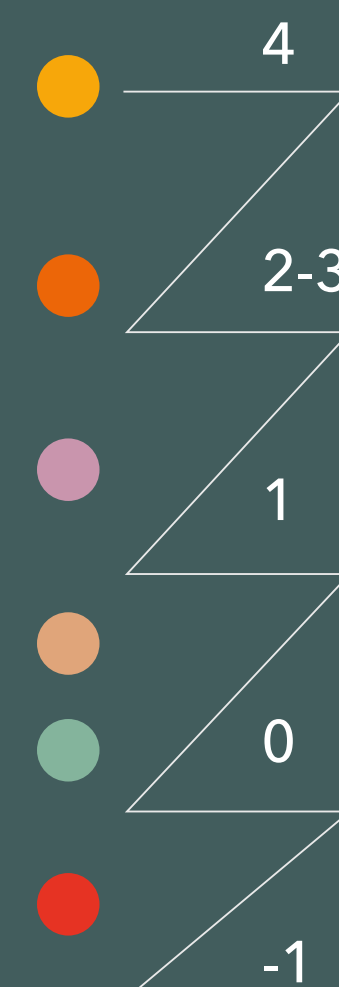

[KLUBKOT.PL](http://KLUBKOT.PL)



REGIONAL FLAVOURS  
FESTIVAL

28.02-1.03.2026



festivalsmakowregionalnych.pl



AMBERIF SPRING

INTERNATIONAL AMBER AND JEWELLERY FAIR

19-21.03.2026

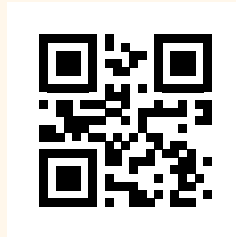

amberif.pl



AMBERIF AUTUMN

INTERNATIONAL AMBER AND JEWELLERY FAIR

4-6.09.2025

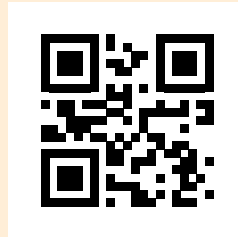

amberif.pl



POWER  
CONNECT  
ENERGY SUMMIT

ENERGY FAIR AND CONFERENCE

25-27.03.2026

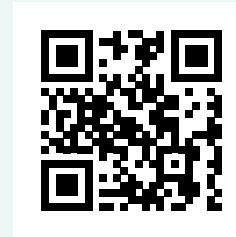

powerconnect.pl



TRAKO

16. INTERNATIONAL RAILWAY FAIR

23-26.09.2025



trakoexpo.com



BALTEXPO

23. INTERNATIONAL MARITIME AND MILITARY FAIR

7-9.10.2025

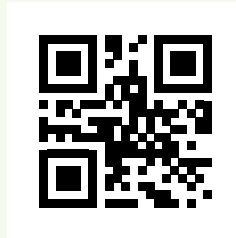

baltexpo.eu



INSIDE  
SEASIDE

FESTIVAL '25

8-9.11.2025

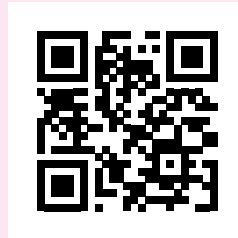

insideseaside.pl



POLFISH

INTERNATIONAL FAIR OF FISH AND FOOD PRODUCTS

9-11.09.2026

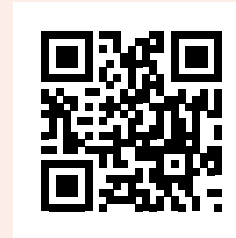

polfishtargi.pl





LET'S CONNECT  
AT AMBEREXPO!



Exhibition & Convention Center  
Gdańsk International Fair Co.

Żaglowa 11, 80-560 Gdańsk, PL  
t. +48 58 554 92 00

GENERAL INQUIRIES  
[sekretariat@amberexpo.pl](mailto:sekretariat@amberexpo.pl)

SALES INQUIRIES  
[sprzedaz@amberexpo.pl](mailto:sprzedaz@amberexpo.pl)



VISIT  
**US**